

當液晶顯示幕顯示“Jam XXX”錯誤訊息時，即代表印表機發生夾紙，“XXX”指示發生夾紙的地方，請依照下列的操作步驟，取出夾紙。

### Jam MP A, Jam C1 A, Jam C2 A, Jam C3 A - 紙張夾在紙匣中

1

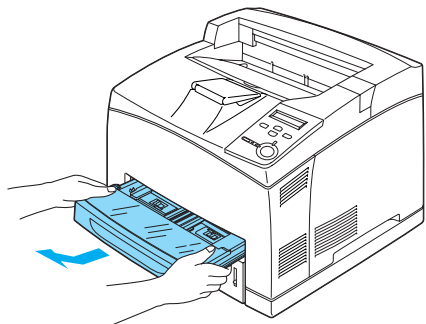

3

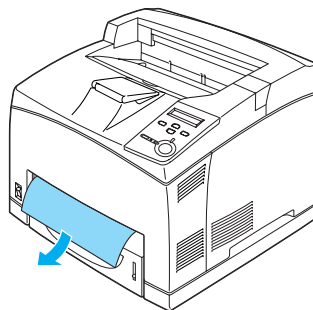

5

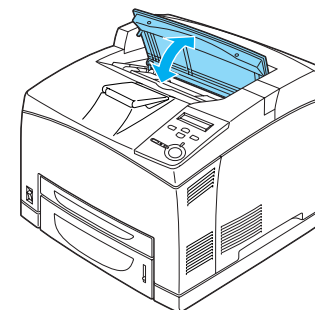

2

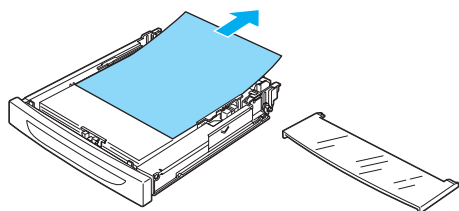

如果印表機中裝有 1 個以上的紙匣，請依照步驟 1 和步驟 2，移除紙匣。

4

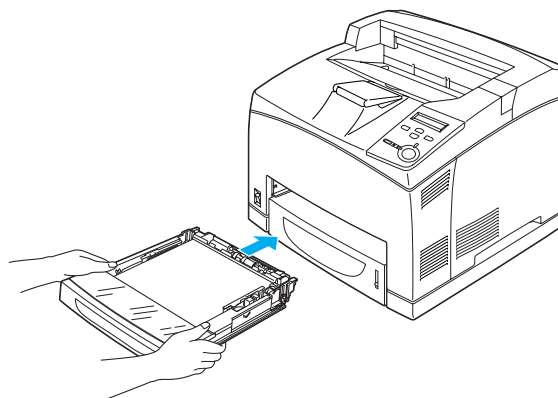

若印表機有安裝選購紙匣，請將所有的紙匣重新裝回印表機中。

### Paper jam - MP tray

請取出萬用進紙匣中的紙張，再移除萬用進紙匣中的夾紙。打開再闔上印表機的前方護蓋，清除液晶顯示幕上的錯誤訊息，將紙張重新放置在萬用進紙匣中，印表機會從夾紙的那一頁開始列印。

## Jam A - 紙張夾在印表機中 (護蓋 A)

1

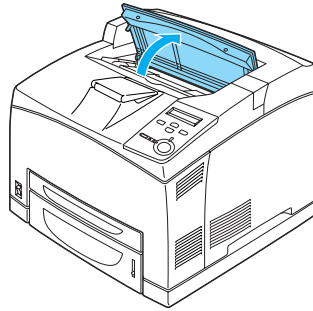

3

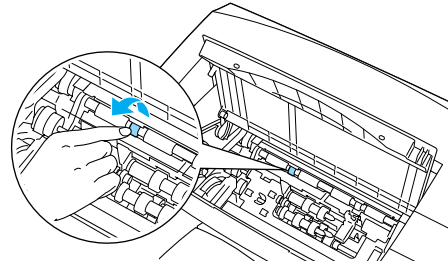

5

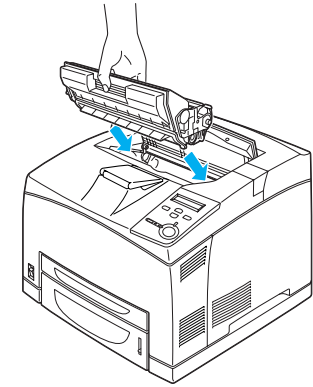

注意：

請不要碰觸到印表機內部標示著

“CAUTION HOT SURFACE / 注意！表面  
高溫避免觸碰”字樣的加熱器或周圍的部  
位。若剛使用印表機列印資料，則加熱器  
和周圍的溫度可能非常高。

4

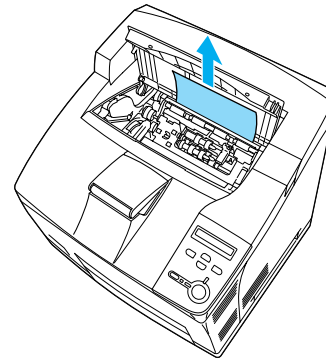

6

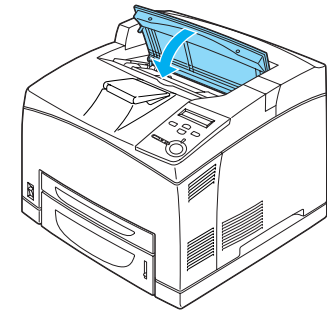

2

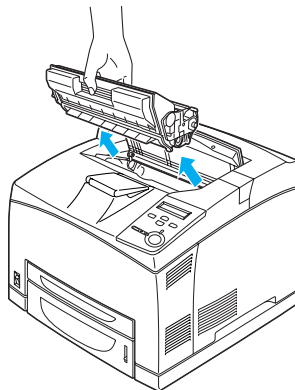

## Jam A B - 紙張夾在印表機中 (護蓋 A 或 B)

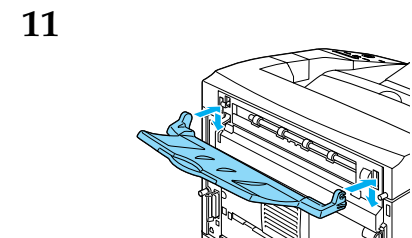
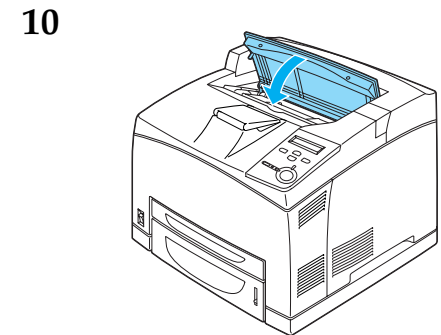
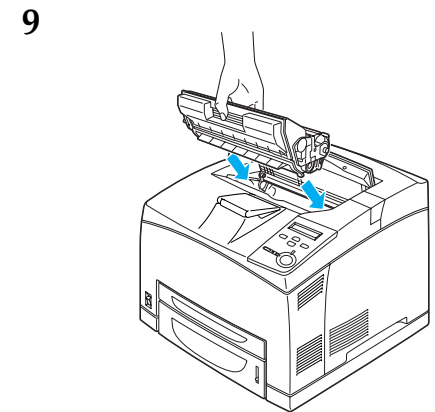
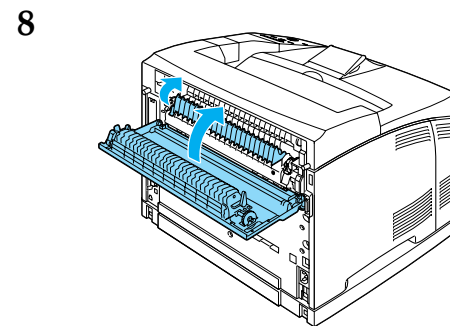
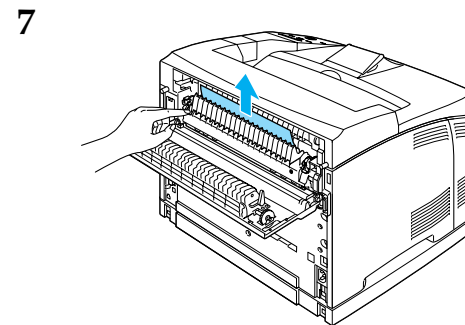
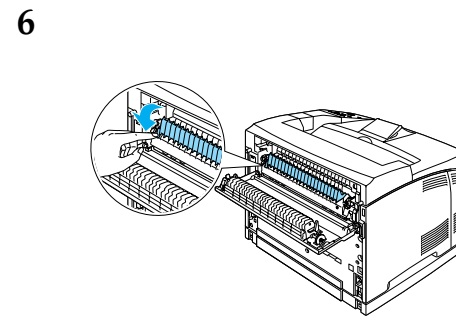
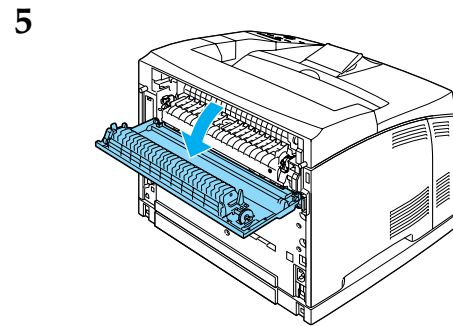
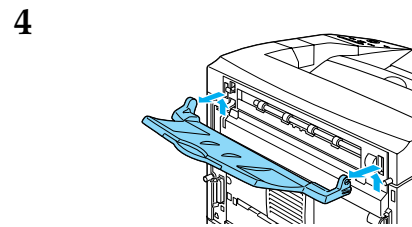
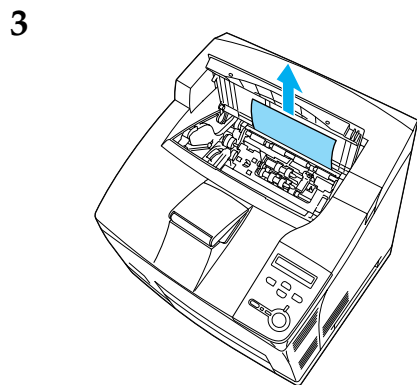
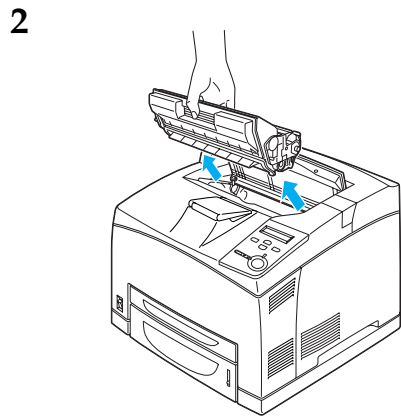
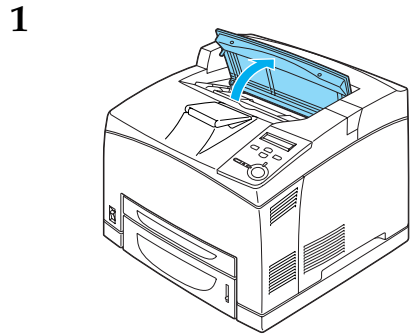

### 警告：

請不要碰觸到印表機內部標示著“CAUTION HOT SURFACE / 注意！表面高溫避免觸碰”字樣的加熱器或周圍的部位。若剛使用印表機列印資料，則加熱器和周圍的溫度可能非常高。若您必須碰觸這些部位，請先關閉印表機的電源，稍候 40 分鐘，再碰觸印表機。

### ***Jam DM - Duplex Unit***

1

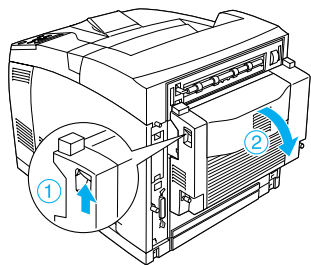

2

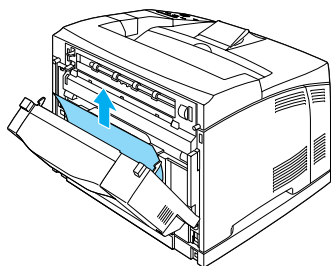

若無法清除夾紙錯誤訊息，請移除雙面列印單元，確認紙張是否夾在印表機中。

### ***Jam STK - Stacker***

1

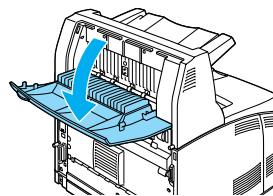

2

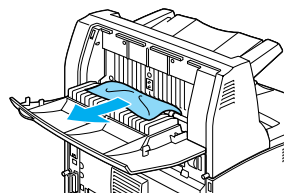

3

