







EN

SC-B6000 Series Setup Guide

TC

SC-B6070 安裝說明

	EN	Assembly	5
	TC	組裝	
			
	EN	Loading Roll Paper	9
	TC	裝入滾筒紙	
			
	EN	Installing the Software	11
	TC	安裝軟體	
	EN	Seeing the Online Guide	14
	TC	請參考線上手冊	

Illustrations

The printer shown in the illustrations in this guide differs in some respects from the actual product, but these differences have no effect on the assembly process.

Safety Instructions

Read all of these instructions before using your printer. Also be sure to follow all warnings and instructions marked on the printer.



Warning

- ❑ Use only the power cord that comes with the printer. Use of another cord may result in fire or electric shock.
- ❑ Wear protective eyewear and gloves when refilling ink tanks.
Should ink contact your skin or enter your eyes or mouth, immediately take the following actions:
 - If fluid adheres to your skin, immediately wash it off using large volumes of soapy water. Consult a physician if the skin appears irritated or is discolored.
 - If fluid enters your eyes, rinse immediately with water. Failure to observe this precaution could result in bloodshot eyes or mild inflammation.
 - If swallowed, induce vomiting and consult a physician immediately.

Caution

- ❑ The printer unit is heavy and unwieldy. Have 4 or more people unpack and assemble the printer and stand.
- ❑ Be careful not to trap your hands or fingers when opening or closing the front cover.
Failure to observe this precaution could result in injury.

Meaning of Symbols

	Caution	Cautions must be followed to avoid bodily injury.
		Important : Important must be followed to avoid damage to this product.
		Note : Notes contain useful or additional information on the operation of this product.

插圖

在此手冊圖示中的印表機的某些方面可能與實機不同，但這些差異性並不會影響到組裝步驟。

安全說明

使用印表機之前，請閱讀下列這些指示說明。同時，請務必遵守印表機上所標示的警告訊息和指示。



警告

- ❑ 只使用此印表機內附的電源線。使用其他的電源線可能會引起火災或造成觸電。
- ❑ 當填充墨水槽的墨水時，請戴上護目鏡和手套。
如果墨水接觸到皮膚或是濺入眼睛或嘴巴，請立即採取下列動作：
 - 若液體沾黏在皮膚上，請立即使用大量的肥皂水沖洗。如果皮膚出現過敏和變色的現象，請找醫師治療。
 - 若液體濺入眼睛，請立刻用水沖洗。不遵守此預防措施可能會導致眼睛充血或輕度發炎。
 - 若有吞入，請催吐並且立刻看醫生。

注意

- ❑ 此印表機裝置沉重且龐大，需要至少 4 人一起拆開包裝和組裝印表機及支架。
- ❑ 當打開或闔上前蓋時請小心，不要弄傷您的手或手指。
不遵守此注意事項可能會造成身體受傷。

圖示說明

	注意	請務必遵守注意事項，以免身體受傷。
		附註：請務必遵守附註事項，以免損壞設備。
		秘訣：提供使用印表機的實用技巧及其他資訊。

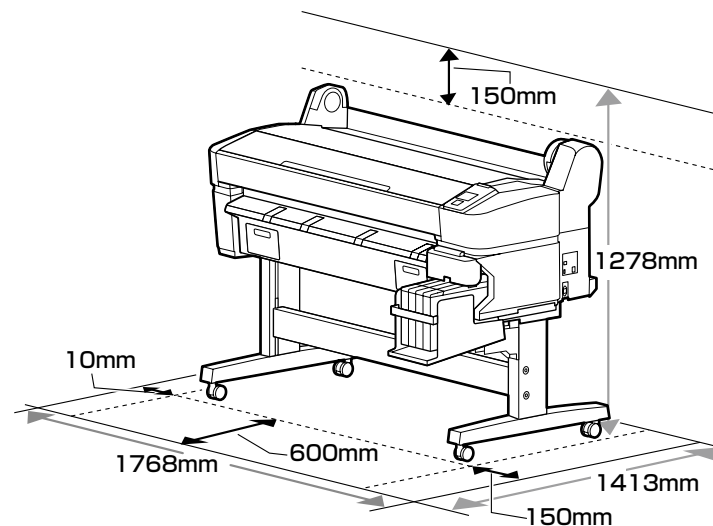

Instructions for Placing the Printer

- ❑ Leave adequate room as shown in the table for setting up the printer.
- ❑ Choose a level and stable location that can support the weight of the printer (90 kg).
- ❑ Use only an outlet that meets the power requirements of this printer.
- ❑ Operate the printer under the following conditions:

Temperature: 15 to 35°C (59 to 95°F)

Humidity: 20 to 80% without condensation

Even the conditions above are met, you may not print properly if the environmental conditions are not proper for the paper. See the instructions of the paper for more detailed information. Keep the printer away from drying, direct sunlight, or heat sources to maintain the appropriate humidity.

放置印表機的說明

- ❑ 請依照圖示，在桌面上預留足夠的空間以設置印表機。
- ❑ 請選擇可支撐印表機重量（90 公斤）並且又平坦又穩固的位置。
- ❑ 僅使用符合此印表機電源規格的電源插座。
- ❑ 請在下列條件下操作印表機：

–溫度：15 至 35°C (59 至 95°F)

–濕度：20 至 80% 無凝結

即使符合了上述條件，但如果環境條件不適合紙張，還是可能會無法正確列印。詳細的資料，請查看紙張的操作說明。

避免將印表機放在過於乾燥、陽光直射、或高溫之處以維持適當的濕度。

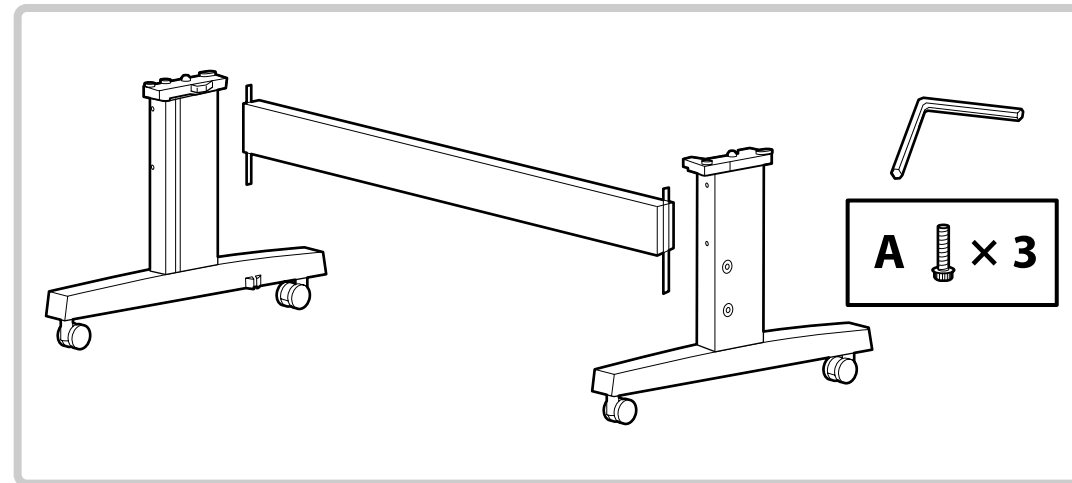
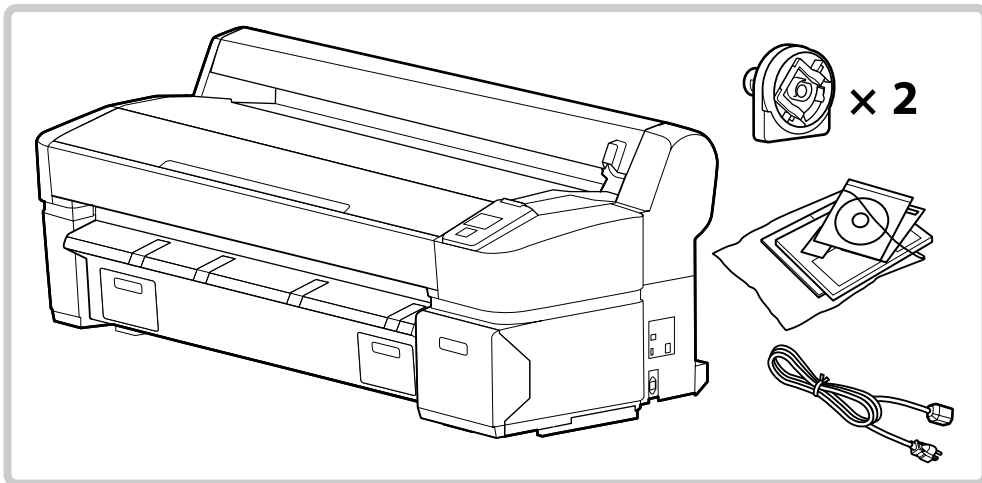

☒ The items in the figure at left may be found in the “Ink Supply System Cover 2” box.
左側圖示中的項目可以在 “Ink Supply System Cover 2” 盒中找到。

⚠ Caution:	Before assembling the printer, clear the work area by putting away the removed packing materials and bundled items.
⚠ 注意：	組裝印表機之前，請先收好拆下的包裝材料及內附的配件，清理工作區域。



EN

Assembly

TC

組裝

Stand

腳架

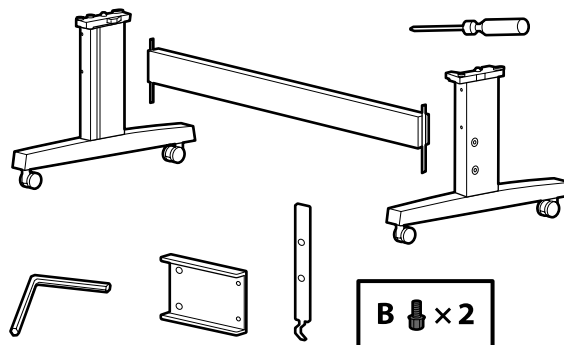

❑ Before assembling the printer, make sure you have a Phillips screwdriver with you.

❑ It is recommended to assemble the stand by a group of three.

❑ 組裝印表機前，請確定已準備好十字螺絲起子。

❑ 建議三人一起組裝腳架。

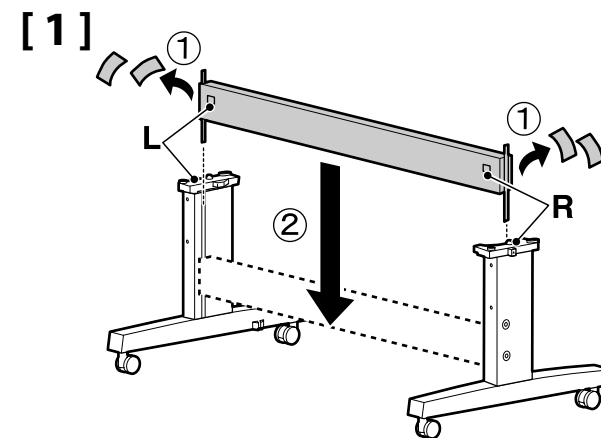
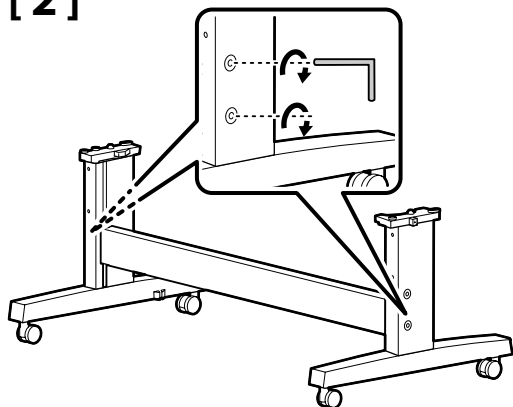
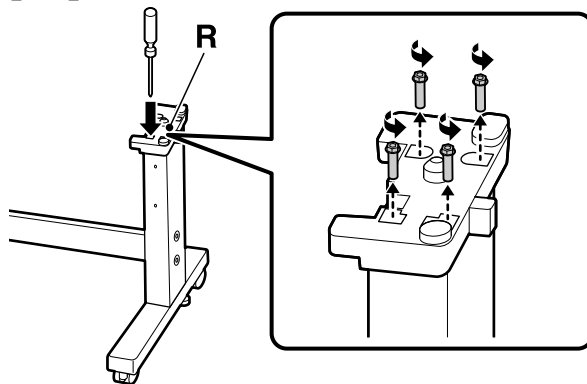
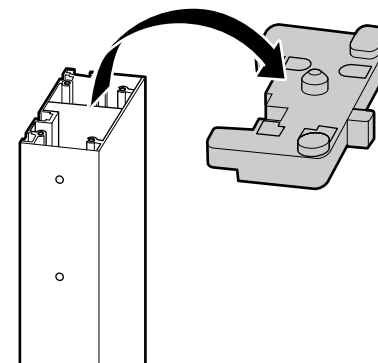
**[2]****[3]****[4]**

[5]

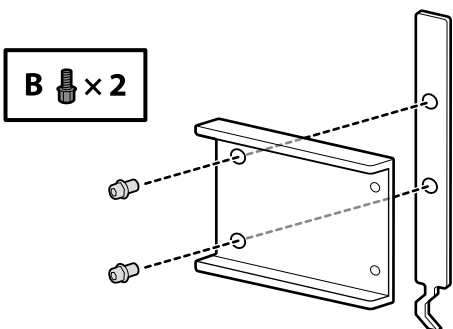

Give the screws shown in the figure a couple of turns to fasten the parts temporarily. The items in the following steps can not be attached if the screws are too tight.

將圖示中的螺絲轉幾圈，暫時固定部件。若螺絲鎖太緊，可能會無法安裝下列步驟中的項目。

[6]

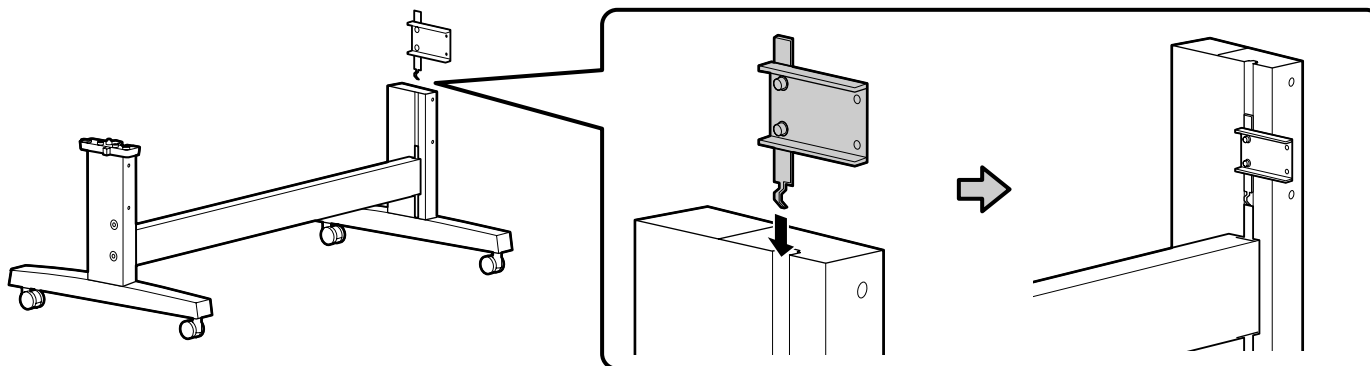

[7]

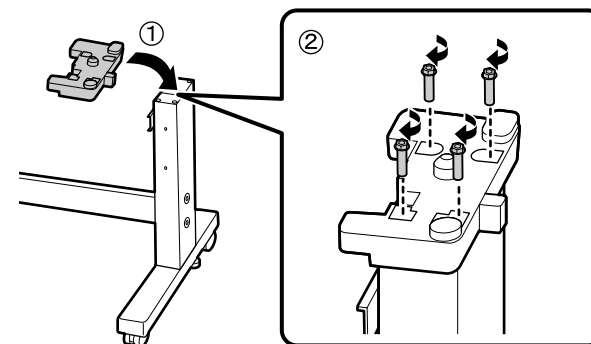

[8]

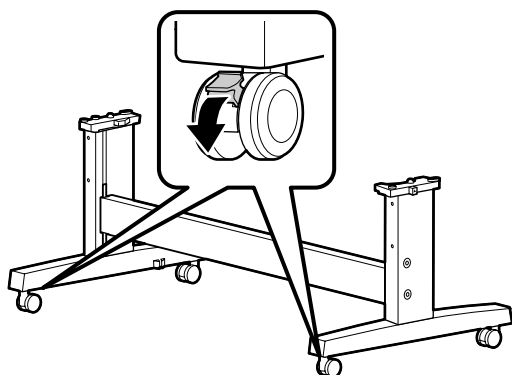

Before using the printer, be sure the stand is fixed in place. When moving the printer, unlock the casters.

使用印表機之前，請確認腳架已固定到位。搬動印表機時，請先將其腳輪解鎖。

Printer Installation

安裝印表機

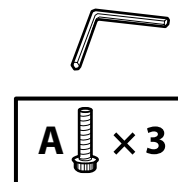
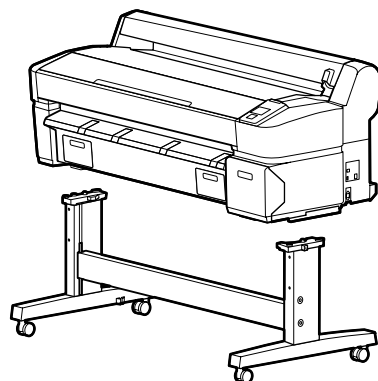

[1]

⚠ Caution:

When carrying the printer, use at least 4 persons.

⚠ 注意：

搬運印表機至少需要 4 人。



When lifting the printer unit, only hold the highlighted area. Otherwise, it may affect normal operation and printing.

抬起印表機裝置時，請僅握住標明的部位，否則可能影響正常操作和列印。

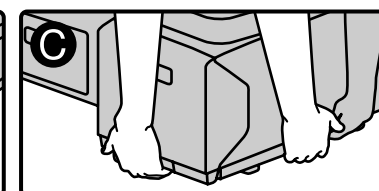
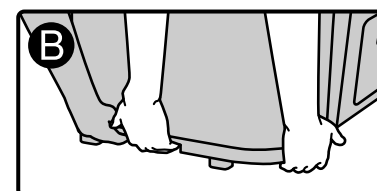
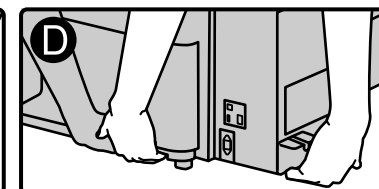
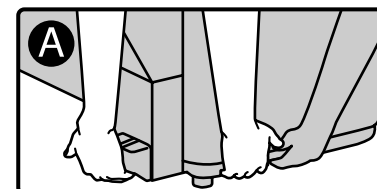
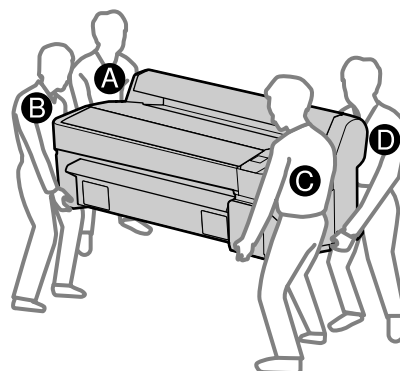

[2]

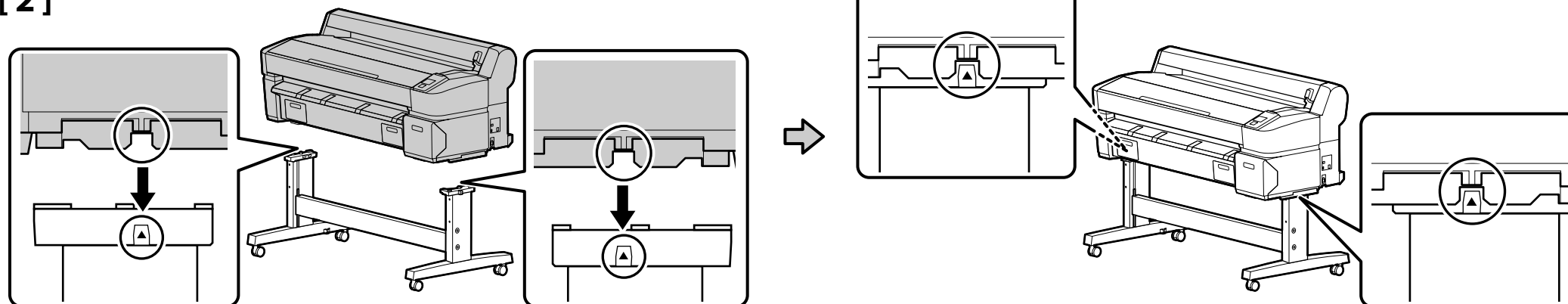

[3]

A  × 3

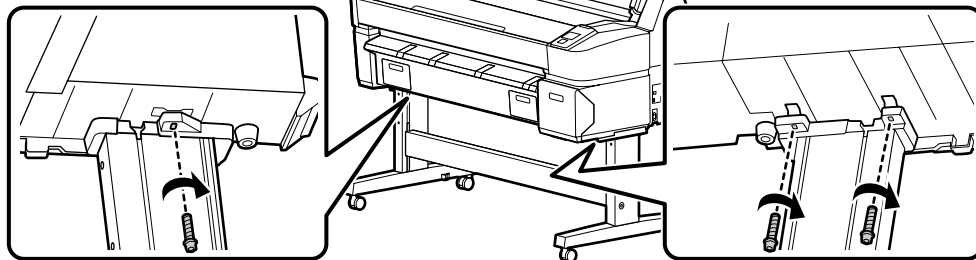

Keep the Allen key in a safe place; do not throw it out.

請妥善保管好 L 型六角扳手；切勿亂扔。

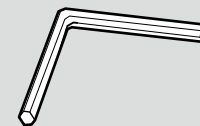

[4]

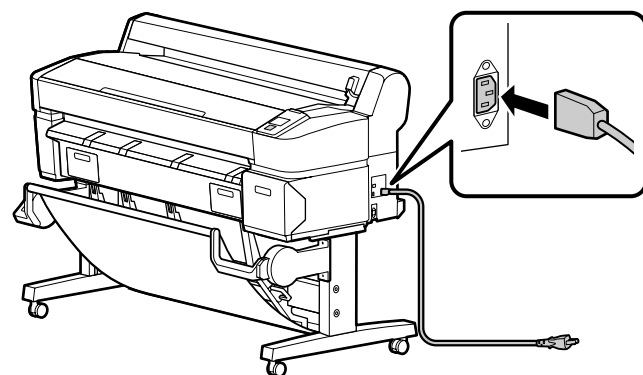

[5]

 **Caution:**

Use only the type of power source indicated on the printer's label.

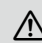
 **注意：**

只使用此印表機標籤上所標示的電源類型。

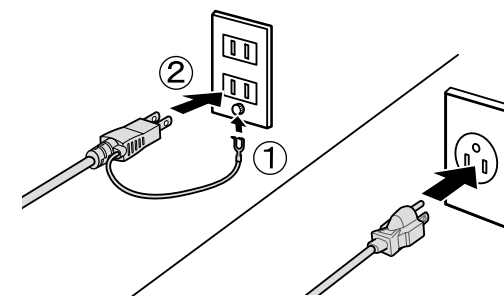

Contact a service engineer to attach the “Epson Genuine Ink Supply System” and “Ink Supply System Cover 2” and adjust the printer. Do not turn the printer on until the service engineer's work is complete.



Attempting to perform these tasks yourself could result in product malfunction or damage to the product and will void the product warranty.

若要安裝“Epson Genuine Ink Supply System”和“Ink Supply System Cover 2”並調整印表機，請洽詢維修工程師。維修工程師未完成工作之前，請勿開啓印表機電源。試圖自行操作這些工作而導致產品故障或損壞，將不提供產品保固服務。

Loading Roll Paper

裝入滾筒紙

[1]

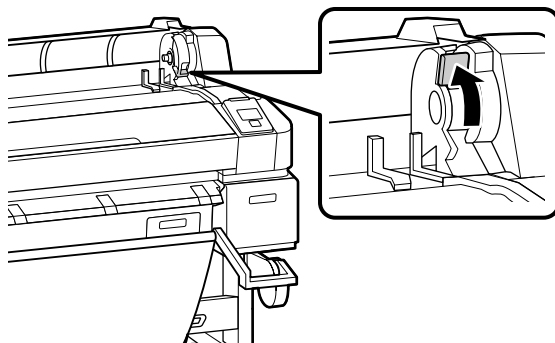

[2]

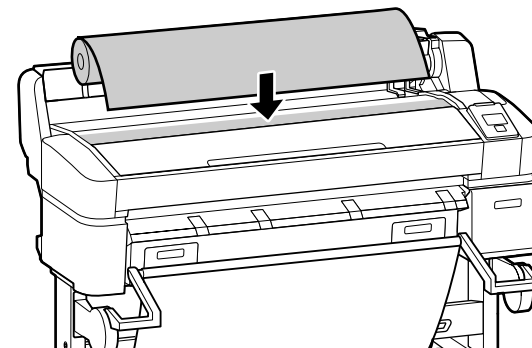

[3]

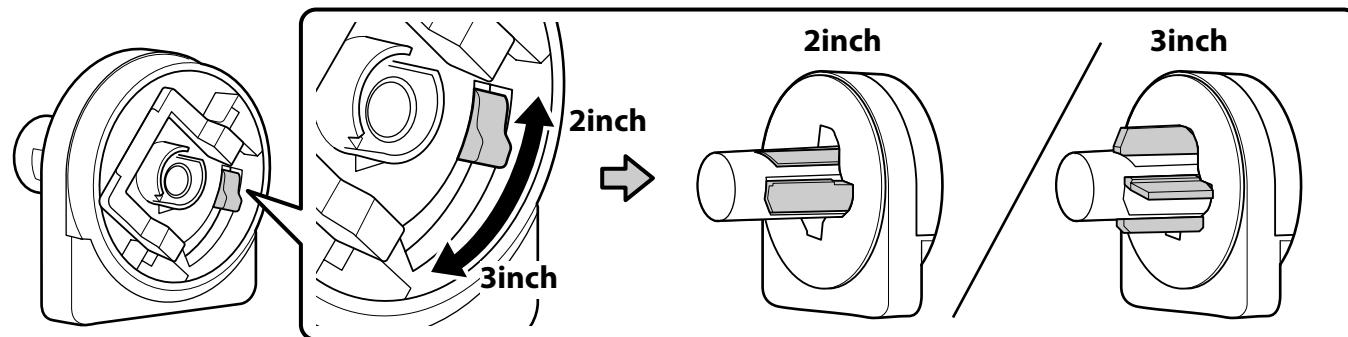

[4]

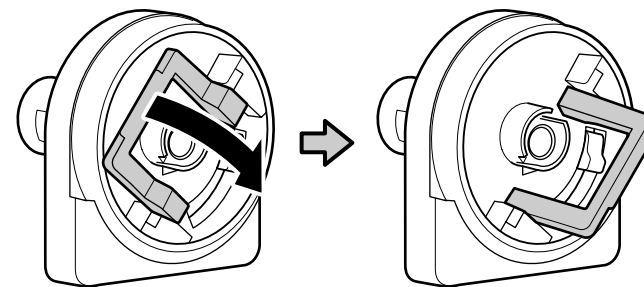

[5]

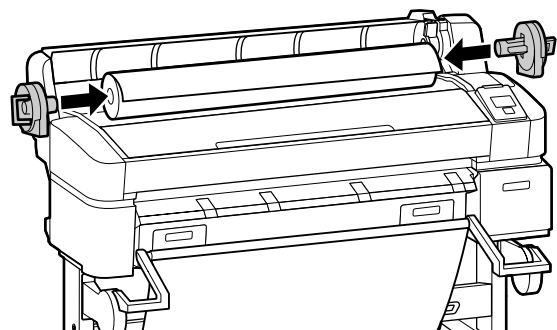

[6]

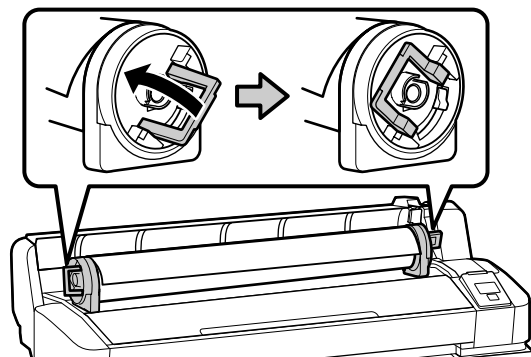

[7]

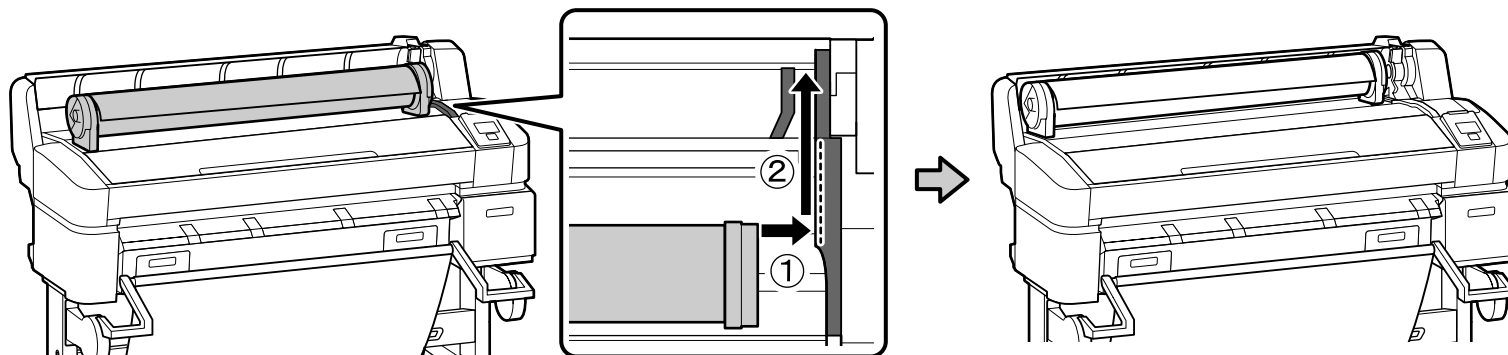

[8]

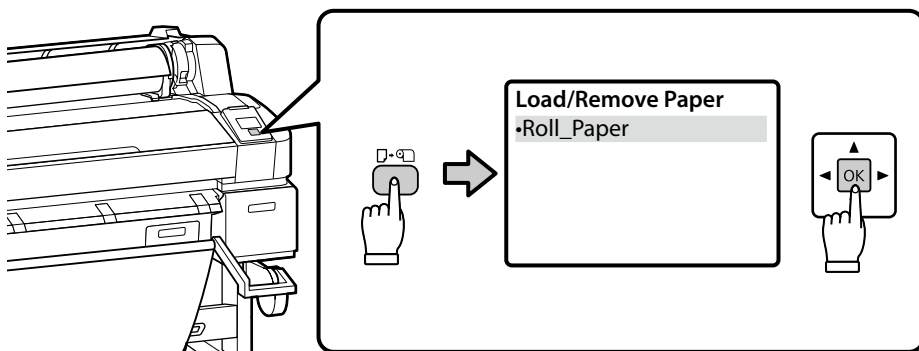

[9]

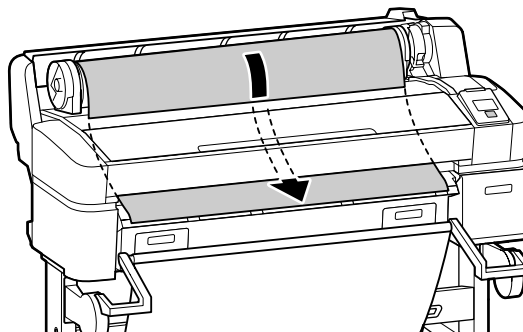

[10]

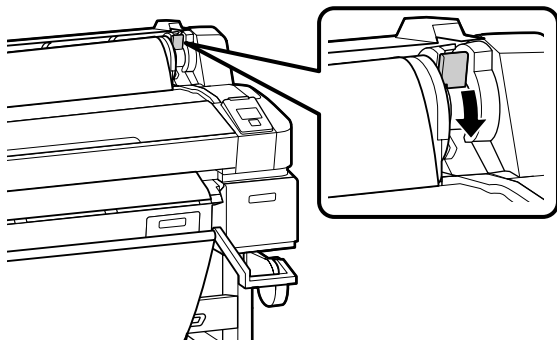

[11]

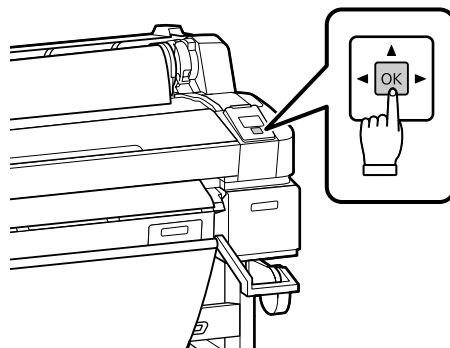

[12]

After loading the media, you will be prompted to choose Paper Type and Roll Paper Remaining options. Choose options as required.

裝入紙張後，您將被提示選擇 Paper Type 和 Roll Paper Remaining 選項。請根據需要選擇選項。



[1]

USB ➔ [1]

Network ➔ [2]

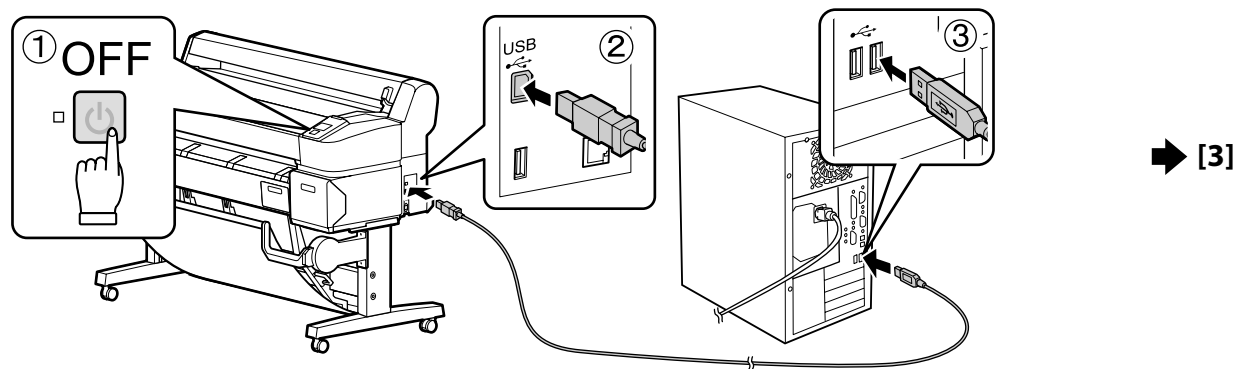

[2]

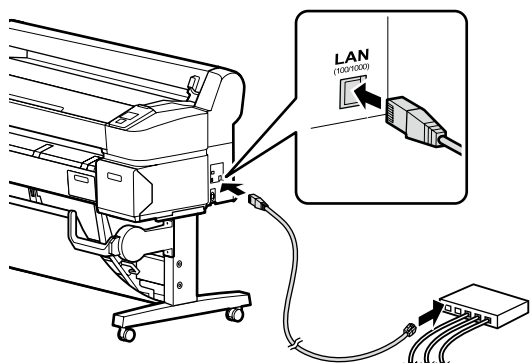

[3]

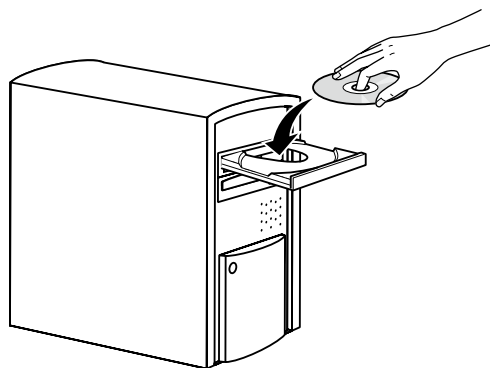

[4]

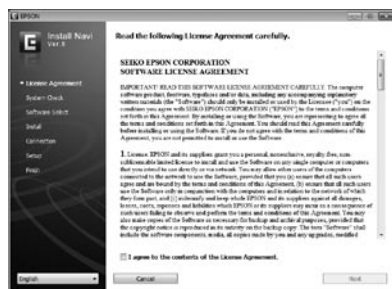

Follow the on-screen instructions to complete the installation.

請依照螢幕上的操作說明，完成安裝步驟。



EN

Installing the Software



安裝軟體

Network



Do not remove the check mark from **Epson Network Utilities** in the Software List.



請勿去除軟體列表中“Epson 網路工具程式”的勾選標記。



If this dialog box appears, make sure the publisher is SEIKO EPSON, and then click **Unblock**.

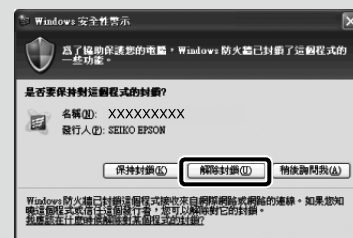

若出現如上圖所示的對話框時，請確認發行者為“SEIKO EPSON”，然後按下“解除封鎖”鍵。

設定密碼（只限於網路）

A screenshot of a web browser's address bar. The address bar contains the text "http://XXXXXXXXXX.XX/XXX". A red rectangular box highlights the domain portion "XXXXXXXXXX.XX". To the right of the address bar, there are icons for back, forward, and search, along with a tab labeled "World Wide Web".

開啓網頁瀏覽器，然後在網址列中輸入印表機的 IP 位址。

The screenshot shows the Epson Remote Manager interface. The 'Setup' tab is highlighted with a red box and a circled '1'. The 'Network' section on the left has the 'Ethernet' sub-section selected. The main area displays the 'Network Summary' for the Ethernet connection, showing details like Administrator Name, Location, MAC Address, and Network Status. At the bottom, the 'Ethernet' sub-section is selected, and the 'Factory Reset' button is highlighted with a red box and a circled '2'.

1. 點選“**Setup**”選單。
2. 在“**Optional**”中按下“**Password**”。
3. 設定您想要的密碼，然後關閉網頁瀏覽器。

Supplied Online Guides

The following online guides are included on the supplied software CD. To view the guides, click **Show** in the **Software Select** screen of software CD. The guides can be copied onto your computer desktop for ease of reference.

	User's Guide
	Network Guide



內附線上手冊

下列線上手冊包含在內附的軟體光碟中。若要查看手冊，請在軟體光碟的“軟體選擇”畫面中按下“顯示”。為了方便日後參考使用，您可將線上手冊複製到電腦的桌面上。

	進階使用說明
	網路使用說明



商品名稱

產品名稱：大圖輸出機

製造年份，製造號碼和生產國別：見機體標示

電力規格

額定電壓：AC100-240V

額定電流：1.0 至 0.5A

額定頻率：50-60 Hz

耗電量（操作時）：約 65W

警語

檢修本產品之前，請先拔掉本產品的電源線。

相容性

適用系統：根據 RIP 的規格而定

使用方法

見內附相關說明文件

緊急處理方法

發生下列狀況時，請先拔下印表機的電源線並洽詢 Epson 授權服務中心：

- ☐ 電源線或插頭損壞
- ☐ 有液體噴灑到印表機
- ☐ 印表機摔落或機殼損壞
- ☐ 印表機無法正常操作或是列印品質與原來有明顯落差

注意事項

- ☐ 只能使用印表機標籤上所註明的電源規格。
- ☐ 請保持工作場所的通風良好。

製造商：SEIKO EPSON CORPORATION

地址：80 Harashinden, Hirooka, Shiojiri-shi, Nagano-ken, 399-0785, JAPAN

電話：81-263-52-2552

進口商：台灣愛普生科技股份有限公司

地址：台北市信義區松仁路 7 號 14 樓

電話：(02) 8786-6688 (代表號)



廢電池請回收



412446100

© 2012 Seiko Epson Corporation. All rights reserved.
Printed in XXXXXX